



61 Fern Road
(3 min)

Millennium Green

Yard Sale

Walkley Cottage

Walkley Green

Open gardens

Page 1

Green spaces

Page 1 + 2

Green spaces guided tour
or self-guided walk

Page 2

For location descriptions, see page 3

Freedom Road
Community Garden

Walkley Road Garden

Burnaby Street Park

96 Carr Road

Rose House
(Yard Sale)

109 Carr Road

Blind
Monkey

Green spaces guided
tour or self-guided walk

Ruskin Park
Blake Street NG
Peace Garden
Philadelphia Gardens
(see page 2)

12 Fir Street

Ruskin Park

2 Duncombe Street

Duncombe Street
Community Garden

The Blake Hotel

Matlock Green

Barber Road

107 Springvale Road
(3-4 min)

Fulton Green

Guided walk
(see page 2)



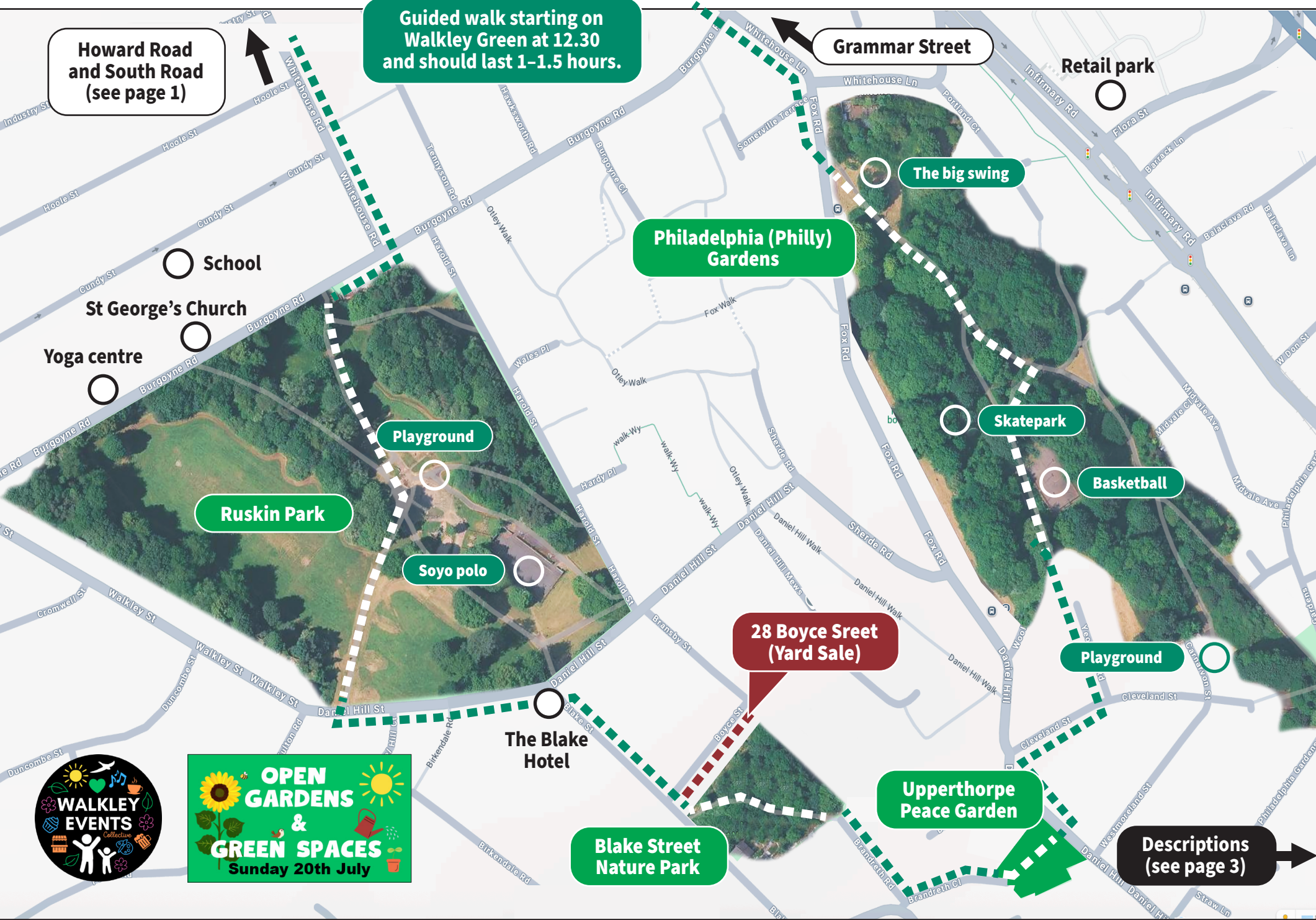

Howard Road
and South Road
(see page 1)

Guided walk starting on
Walkley Green at 12.30
and should last 1-1.5 hours.

Grammar Street

Retail park

The big swing

Philadelphia (Philly)
Gardens

School

St George's Church

Yoga centre

Playground

Ruskin Park

Soyo polo

Skatepark

Basketball

28 Boyce Sreet
(Yard Sale)

Playground

The Blake
Hotel

Blake Street
Nature Park

Upperthorpe
Peace Garden

Descriptions
(see page 3)



Open gardens

61 Fern Road

(just off map from Providence Road)

Steep terraced garden with perennials, mature shrubs and trees. Wildlife friendly.

109 Carr Road

A wild 1/4 acre garden with half a dozen fruit trees (apricot, apple, pear, cherry) and plenty of seating.

Phil, the beekeeper will be on hand to answer bee-related questions. Depending on the weather he may open hives to let visitors see inside. Honey for sale.

Cath, the painter and printmaker, will open her studio with cards and prints for sale, and include a studio sale with many originals with up to 50% discount.

96 Carr Road

Evolving space for nature and children.

12 Fir Street

A garden rich in mature colourful and low maintenance perennials, 42 years in the making. Diverse areas: fruit trees, herbs, species roses, climbers, etc.

Made for wildlife to enjoy.

2 Duncombe Street

Lovely garden next to the community garden and Ruskin Park.

107 Springvale Road

(just off map towards The Springvale PH)

In the lower garden we have established raised beds containing trees and large fruit bushes and a small experimental hydroponic fruit and veg area. Up the hill we have a 1/3 of an acre site consisting of a food forest, nature area, play ground and wood land garden.

Barber Road Garden

(just off map opposite PA Jewellery)

Community garden on the verge of the car park. Sponsored by PA Jewellery.

PA JEWELLERY
SHEFFIELD

Green spaces, parks, nature gardens and guided tour

Walkley Millennium Green

Yard sale and Fundraising.



Yard Sale

Freedom Road Community Garden

Community garden with perennials, craft and cake.

Walkley Road Garden

Community wild space with tube slide for kids.

Burnaby Street Park

Kids saucer and slide.

Walkley Green

The village centre of Walkley.
Walkley Historians / WCC / WECCIC.



Yard Sale

Matlock Green

Village green status.

Fulton Green

Welcome to Walkley green space.

Duncombe Street Community Garden

Delightful community green space.

Grammar Street

(just off map from Whitehouse Lane)

Bouldering wall.

**The following can be done
by yourself or on our guided tour
starting on Walkley Green at 12.30**

Ruskin Park

The site of Walkley's famous festivals over the years, Ruskin Park is a lovely smallish park created in the late 1970s / early 1980s when three streets were demolished as part of a slum clearance operation by Sheffield City Council. Lots of open space, trees, and children's play area.

Blake Street Nature Garden

A small, semi-wild green space known for its natural vegetation and biodiversity. This park emphasises ecological preservation, with footpaths weaving through grassy meadows and wildflower areas.

Upperthorpe Peace Garden

This hidden gem is a small, serene green space near Zest. It has a tranquil atmosphere with well-maintained flower beds, shaded benches, and a community-led gardening project. It serves as a place for reflection and relaxation for locals and visitors alike. Despite its modest size, the garden plays an important social role, sometimes hosting small events and community gatherings.

Philadelphia Gardens

This covers a large part of the area where the infamous Kelvin Flats once towered over until being demolished in the late 1990s. It was then developed into a recreational area but became swamped with trees, overgrown bushes and antisocial behaviour.

In 2022 Wilder Walkley took advice from the Sheffield and Rotherham Wildlife Trust Community Nature Advisors for site improvements with wildflower planting and tree thinning to discourage antisocial behaviour and improve visitor experiences.

Since then there has been a small group who have sought to clear the unsightly parts of the area and plant wildflowers to create a space for nature and a space for people.

